

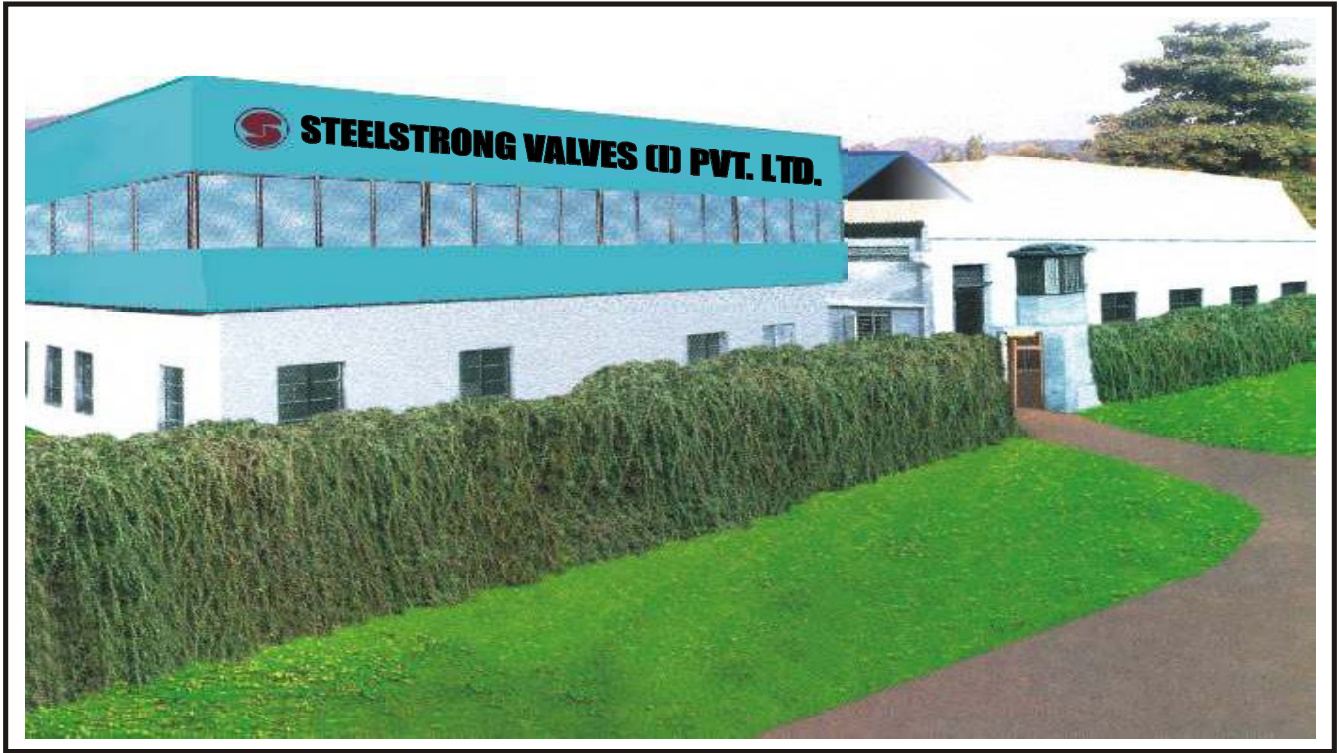

ALWAYS STRONG IN VALVE WORLD



**STEELSTRONG**



**Head Office & Plant I**



**Plant II**



**STEELSTRONG** is synonymous with the industrial valve industry for over two decades. We have three strategically located manufacturing plants in Maharashtra and Gujarat to cater to the growing demands of this industry.

As market leaders in industrial valves, we ensure and set trends for quality in the Indian sub-continent. In fact we are the first company to achieve Dual registration from API for ISO 9001 and API-6D Monogram Facilities. Today we have acquired four API licenses to manufacture valves and oil field equipments.

Our products are widely used and endorsed by the Oil and Gas industry, Power, Fertilizer, Petrochemical and Process industry in India and Overseas.

Our commitment to quality assures a growing customer base and our after sales support speaks volumes of our dedication towards you.

Yes, we continue to aim to be the best valve manufacturers of international standards.

**RAMESH SHETTY**

*Chairman & Managing Director*

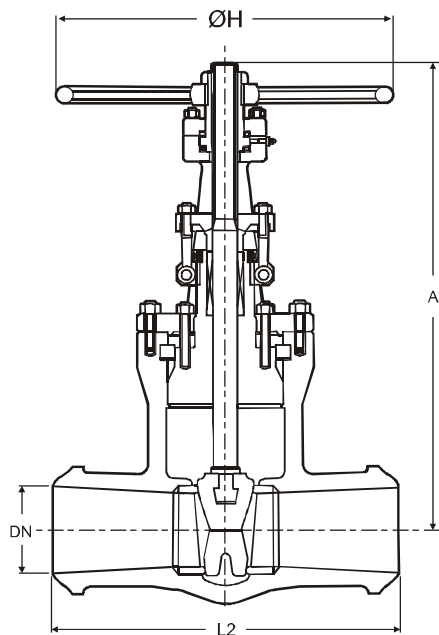

**Pressure Seal Gate Valve  
Class 900/ 1500/ 2500**

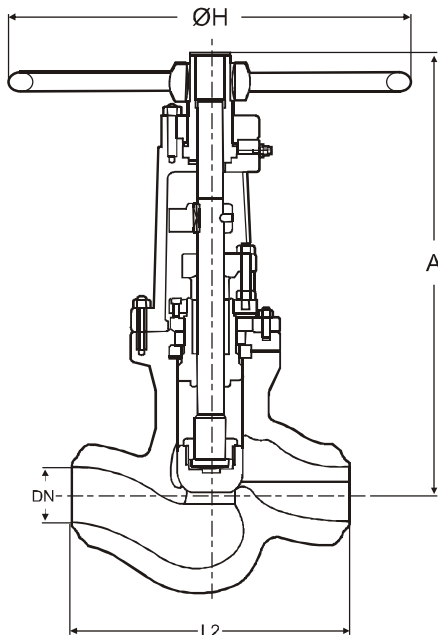

**Pressure Seal Globe Valve  
Class 900/ 1500/ 2500**

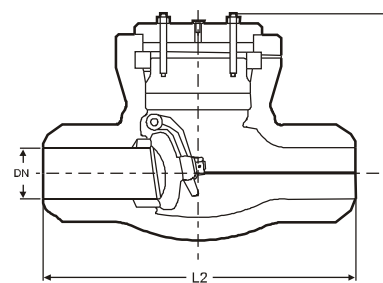

**Pressure Seal Swing Check Valve  
Class 900/ 1500/ 2500**

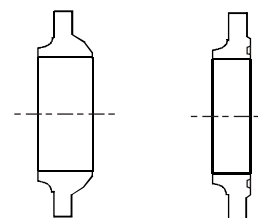

**L2                      L3  
Butt-Weld End      RTJ**

## MATERIALS OF CONSTRUCTION

DESCRIPTION	WCB	LCB	CF8M	WC6/ WC9/ C5
BODY (1)	ASTM A 216 Gr. WCB	ASTM A 352 Gr. LCB	ASTM A 351 Gr. CF8M	ASTM A 217 Gr. WC6/WC9/C5
SEAT RING (2, 3)	Stellited	Stellited	Stellited	Stellited
PLUG/ DISC/ WEDGE (2, 3)	Stellited	Stellited	Stellited	Stellited
STEM (2)	A 276 TP 410	A 276 TP 304	A 276 TP 316	A 276 TP 410
GASKET (2)	SOFT IRON	SS 304	SS 316	SS 304
BONNET (1)	A 216 Gr. WCB	A 352 Gr. LCB	A 351 Gr. CF8M	A 217 Gr. WC6 / WC9 / C5
YOKE/ COVER (1)	A 216 Gr. WCB	A 352 Gr. LCB	A 351 Gr. CF8M	A 217 Gr. WC6 / WC9 / C5
YOKE/ COVER STUDS & NUTS	A 193 Gr. B7 & A 194 Gr. 2H	A 320 Gr. L7 & A 194 Gr. 4/7	A 193 Gr. B7 & A 194 Gr. 2H	A 193 Gr. B 16/ A 194 Gr. 4/7
GLAND PACKING	GRAPHITE RINGS	GRAPHITE RINGS	GRAPHITE RINGS	GRAPHITE RINGS
GLAND BUSH (2)	A276 TP 410	A 276 TP 304	A 276 TP 316	A 276 TP 410
GLAND FLANGE (2)	A 105/ CARBON STEEL	A 105/ CARBON STEEL	A 182 F 316 / CARBON STEEL	A 182 F 5 / CARBON STEEL
CROSS BOLTS & NUTS	A 307 Gr. B & A 563 Gr. A	A 307 Gr. B & A 563 Gr. A	A 307 Gr. B & A 563 Gr. A	A 307 Gr. B & A 563 Gr. A
EYE BOLTS & NUTS	A 307 Gr. B & A 563 Gr. A	A 307 Gr. B & A 563 Gr. A	A 307 Gr. B & A 563 Gr. A	A 307 Gr. B & A 563 Gr. A
YOKE SLEEVE	A 439 Gr. D2	A 439 Gr. D2	A 439 Gr. D2	A 439 Gr. D2
HAND WHEEL	MALLEABLE IRON/ DUCTILE IRON	MALLEABLE IRON/ DUCTILE IRON	MALLEABLE IRON/ DUCTILE IRON	MALLEABLE IRON/ DUCTILE IRON

### Also Available

- (1) Casting in **WCC, LCC, CF8, CF3, CF8C, CN7M, C12, DUPLEX SS, HASTALLOY, MONEL**, also provided against requirement.
- (2) With different combination for WCB valves.
- (3) Special features like stelliting.



## DESIGN FEATURES

- Design standard as per API 600 / ASME B16.34/ ISO 10434
- Flange details as per ASME B 16.5
- Butt-weld end dimension as per ASME B 16.25.
- Face to Face dimension as per ASME B 16.10
- Testing Standard as per API 598 / BSEN 12266 / MSS SP 61

## SPECIAL FEATURES

- With Gear operation - if the applied force exceeds 350 N
- With Limits Switch arrangements for open & close position.
- With Electrical Actuator.
- With Locking arrangement.
- With By-pass arrangement.

## TOLERANCE

- 1) Face to Face : +/- 2.0mm upto NPS 10" and smaller, +/- 3mm for NPS 12 & larger.

## FACE TO FACE / END-TO-END DIMENSIONS FOR GATE VALVES (Class 900,1500 & 2500)

CLASS 900	NPS in	2"	3"	4"	6"	8"	10"	12"	14"	16"	
	DN mm	50	80	100	150	200	250	300	350	400	
	L1 (RF)	368	381	457	610	737	838	965	1029	1130	
	L2 (BWE)	368	381	457	610	737	838	965	1029	1130	
	L3 (RTJ)	371	384	460	613	740	790	968	1038	1140	
	ΦH	250	300	350	500	600	600	600	650	650	
	A	480	570	670	880	1080	1295	1490	1800	1999	
	WT.IN	F/E	73	99	170	305	510	805	1081	1506	1850
	KG.	BWE	55	77	130	280	475	760	1010	1420	1460

CLASS 1500	NPS in	2"	3"	4"	6"	8"	10"	12"	
	DN mm	50	80	100	150	200	250	300	
	L1 (RF)	368	470	546	705	832	991	1130	
	L2 (BWE)	368	470	546	705	832	991	1130	
	L3 (RTJ)	371	473	549	711	842	1000	1146	
	ΦH	250	300	350	500	450	450	600	
	A	490	575	590	950	1100	1350	1501	
	WT.IN	F/E	80	110	210	330	550	850	1150
	KG.	BWE	58	82	160	310	525	810	1080

CLASS 2500	NPS in	2"	3"	4"	6"	8"	10"	12"	
	DN mm	50	80	100	150	200	250	300	
	L1 (RF)	451	578	673	914	1022	1270	1422	
	L2 (BWE)	451	578	673	914	1022	1270	1422	
	L3 (RTJ)	454	584	683	927	1038	1292	1445	
	ΦH	350	450	500	600	600	600	600	
	A	550	580	850	1420	1510	1980	2150	
	WT.IN	F/E	110	150	250	380	610	920	1250
	KG.	BWE	88	122	200	360	585	880	1180

## FACE TO FACE / END-TO-END DIMENSIONS FOR GLOBE VALVES (Class 900,1500 & 2500)

CLASS 900	NPS in	2"	3"	4"	6"	8"	
	DN mm	50	80	100	150	200	
	L1 (RF)	368	381	457	610	737	
	L2 (BWE)	368	381	457	610	737	
	L3 (RTJ)	371	384	460	613	740	
	ΦH	350	450	500	610	610	
	A	590	699	795	1108	1184	
	WT.IN	F/E	95	108	195	435	720
	KG.	BWE	75	85	158	360	597

CLASS 1500	NPS in	2"	3"	4"	6"	8"	
	DN mm	50	80	100	150	200	
	L1 (RF)	368	470	546	705	832	
	L2 (BWE)	368	470	546	705	832	
	L3 (RTJ)	371	473	549	711	842	
	ΦH	350	500	560	610	610	
	A	590	582	795	1278	1960	
	WT.IN	F/E	95	512	350	560	990
	KG.	BWE	75	179	299	462	830

CLASS 2500	NPS in	2"	3"	4"	6"	8"	
	DN mm	50	80	100	150	200	
	L1 (RF)	451	578	673	914	1022	
	L2 (BWE)	451	578	673	914	1022	
	L3 (RTJ)	454	584	683	927	1038	
	ΦH	400	560	610	610	610	
	A	720	885	1260	1905	2465	
	WT.IN	F/E	176	308	759	1990	4390
	KG.	BWE	141	238	644	1700	3950

## FACE TO FACE / END-TO-END DIMENSIONS FOR SWING CHECK VALVES (Class 900,1500 & 2500)

CLASS 900	NPS in	2"	3"	4"	6"	8"	10"	12"	14"	16"	
	DN mm	50	80	100	150	200	250	300	350	400	
	L1 (RF)	368	381	457	610	737	838	965	1029	1130	
	L2 (BWE)	368	381	457	610	737	838	965	1029	1130	
	L3 (RTJ)	371	384	460	613	740	841	968	1038	1140	
	A	296	300	327	441	502	664	775	782	838	
	WT.IN	F/E	70	91	150	305	510	810	1120	1380	1900
	KG.	BWE	50	68	113	230	387	632	901	1139	1613

CLASS 1500	NPS in	2"	3"	4"	6"	8"	10"	12"	14"	16"	
	DN mm	50	80	100	150	200	250	300	350	400	
	L1 (RF)	368	470	546	705	832	991	1130	1257	1384	
	L2 (BWE)	368	470	546	705	832	991	1130	1257	1384	
	L3 (RTJ)	371	473	549	711	842	1000	1146	1276	1407	
	A	296	341	412	511	680	756	857	950	1020	
	WT.IN	F/E	70	150	245	550	1010	1550	2280	3060	4500
	KG.	BWE	50	115	190	452	845	1280	1780	2290	3500

CLASS 2500	NPS in	2"	3"	4"	6"	8"	10"	12"	
	DN mm	50	80	100	150	200	250	300	
	L1 (RF)	451	578	673	914	1022	1270	1422	
	L2 (BWE)	451	578	673	914	1022	1270	1422	
	L3 (RTJ)	454	584	683	927	1038	1292	1445	
	A	416	441	479	511	711	851	1000	
	WT.IN	F/E	145	330	650	1400	2420	3750	5500
	KG.	BWE	110	260	535	1110	1980	2980	4350



**GATE VALVE**



**GATE VALVE**



**HIGH PRESSURE MOTORISED VALVE**



**'Y' TYPE STRAINER**



**SWING CHECK VALVE**



**FS GATE VALVE**



**GLOBE VALVE**



**FORGED STEEL  
GLOBE VALVE**



**FORGED STEEL  
LIFT CHECK VALVE**

**Head Office & Plant I**  
**STEELSTRONG VALVES (I) PVT. LTD.**

Plot No.R-241, TTC Industrial Area,  
M.I.D.C., Rabale,  
Navi Mumbai 400 701.  
Phones: (91-22) 27695536 / 27690074  
Fax: (91-22) 27695537  
Email: steelstrongvalve@mtnl.net.in  
adminsteelstrong@steelstrong.com  
website: www.steelstrong.com

**Plant II**

Plot No. B/176, 186, 187,  
Ajanta Industrial Estate,  
Village: Vasna Iyava,  
Taluka: Sanand  
Ahmedabad - 382 170  
Gujarat.  
Phone: 02717-619100 / 619109 / 619115  
Email: sanandworks@steelstrong.com

